

# STATE OF TEXAS DEPARTMENT OF TRANSPORTATION

UTILITIES: SEE SHEET 2 FOR KNOWN UTILITIES

## PLANS OF PROPOSED RIGHT OF WAY PROJECT

U.S. 77 - NUECES COUNTY

PROJECT LIMITS: FROM CR 16  
TO KLEBERG COUNTY LINE

TOTAL LENGTH OF PROJECT: 4.880 MILES

### CSJ LIMITS

FROM C.R. 16 TO F.M. 3354:

CONSTRUCTION CSJ NO. : 0102-03-082

R.O.W. CSJ NO. : 0102-03-084

FROM F.M. 3354 TO KLEBERG COUNTY LINE:

CONSTRUCTION CSJ NO. : 0102-03-081

R.O.W. CSJ NO. : 0102-03-085

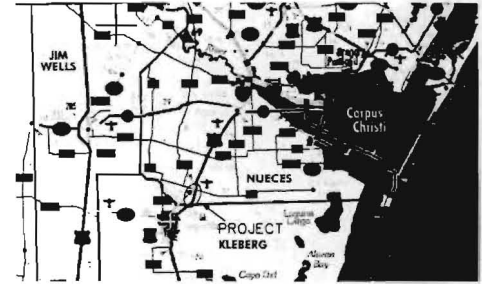

VICINITY MAP  
(NOT TO SCALE)

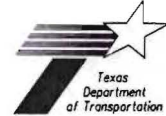
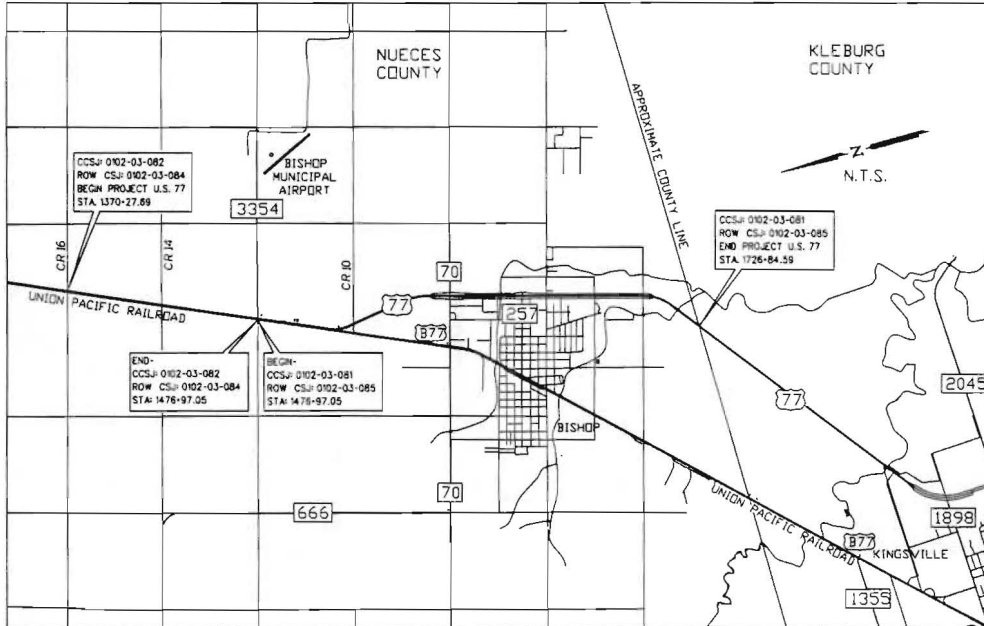

RECOMMENDED FOR ACQUISITION OF RIGHT OF WAY \_\_\_\_\_ DATE \_\_\_\_\_

DISTRICT SURVEYOR \_\_\_\_\_  
**PRELIMINARY**  
**SUBJECT TO REVISION**

RECOMMENDED FOR ACQUISITION OF RIGHT OF WAY \_\_\_\_\_ DATE \_\_\_\_\_

AREA OR PROJECT ENGINEER \_\_\_\_\_

FINAL APPROVAL \_\_\_\_\_ DATE \_\_\_\_\_

DISTRICT ENGINEER \_\_\_\_\_

TY, TEXAS  
INTY, TEXAS  
Y, TEXAS

S SHALL  
STEM, SOUTH ZONE, NAD 83/93 DATUM AS  
; SURFACE ADJUSTMENT FACTOR 1.0006.  
A COMPUTED

NO EQUATIONS  
NO ADDITIONAL R.O.W. WILL BE REQUIRED FROM  
STATION 1586+05.37 TO STATION 1726+84.59.

**SURVOTEX LLC** 600 W. Whitestone Blvd.  
Cedar Park, Texas 78613  
Professional Surveying and Mapping Services (512) 249-8875  
Fax (512) 249-5040

SURVTEX #: 2012-0009 Date: 08-10-2012

FED. ROAD DIV. NO.	STATE	FEDERAL AID PROJECT NO.	SHT. NO.		
	TEXAS		1 OF 34		
STATE DISTRICT	COUNTY	CONT. NO.	SEC. NO.	JOB NO.	HIGHWAY NO.
CORPUS CHRISTI	NUECES	0102 0102	03 03	084 085	U.S. 77

FILE/REF. FILE(S): 12-0009-RBORDER.DGN